

ALUDRA

GHID DE INSTALARE RAPIDA
QUICK START GUIDE

RO / EN



Ghid de instalare rapida
Quick Start Guide

MULTUMIMI!

THANK YOU!

RO

Va multumim ca ati ales ALUDRA ca piesa centrala a echipamentului dumneavoastra de gaming!
Va rugam sa urmati instructiunile din manualul de utilizare pentru a finaliza cu succes instalarea noului echipament.

#SOLID #SMOOTH #FAST #ELEMENTAL

Welcome to the feel of AQIRYS®!

EN

Thank you for handpicking ALUDRA to be the centerpiece of your gaming gear! Please, follow the instructions from the user manual to successfully complete the installation of your new gear.

#SOLID #SMOOTH #FAST #ELEMENTAL

Welcome to the feel of AQIRYS®!



Ghid de instalare rapida
Quick Start Guide

CONTINUTUL PACHETULUI

INSIDE THE BOX

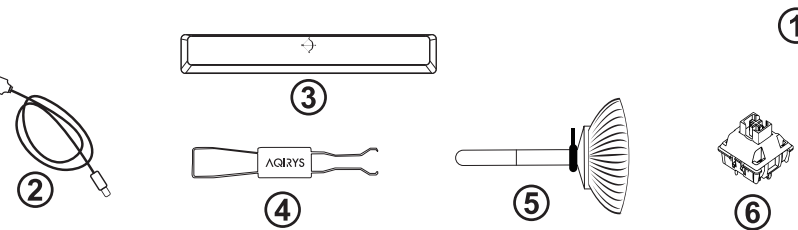
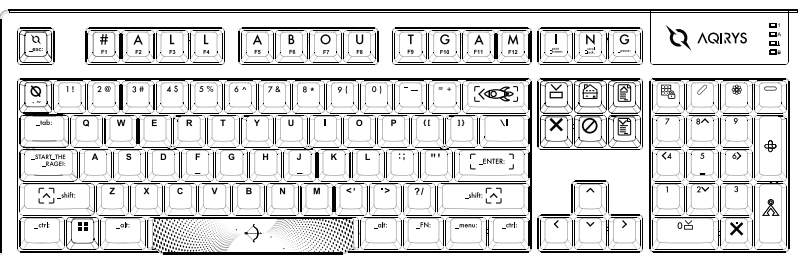

RO

1. Tastatura mecanica ALUDRA
2. Cablu detasabil USB Type-C
3. Tasta spacebar subtire
4. Extractor capace taste si contacte mecanice
5. Perie pentru curatare
6. 20 de contacte tactile (5 pini)

EN

1. ALUDRA mechanical keyboard
2. Detachable USB Type-C cable
3. Slim spacebar
4. Keycap and Switch extractor
5. Cleaning brush
6. 5-pin tactile switch (20 pcs.)



Ghid de instalare rapida
Quick Start Guide

MANAGEMENTUL CABLULUI

CABLE MANAGEMENT

RO

ALUDRA permite utilizarea unui cablu USB Type-C drept si aranjarea acestuia pe sub tastatura, prin intermediul canalelor disponibile, in functie de locul unde doriti sa il pozitionati la iesire.

EN

ALUDRA allows using a straight USB Type-C cable and routing it through the available channels under the keyboard, depending on where you want to position its exit.

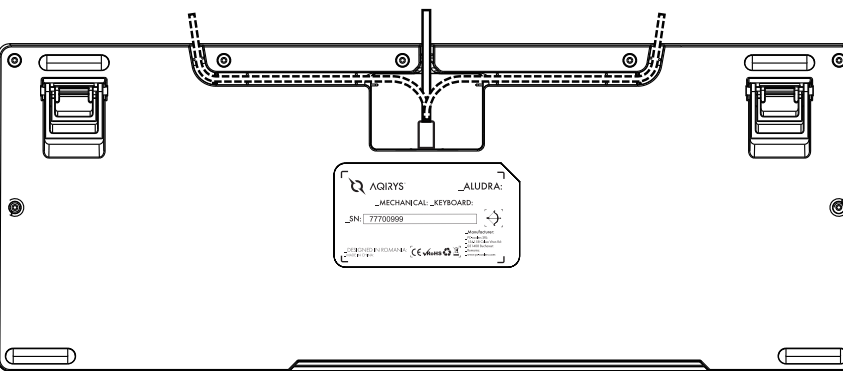

Ghid de instalare rapida
Quick Start Guide

INSTALARE

SETUP

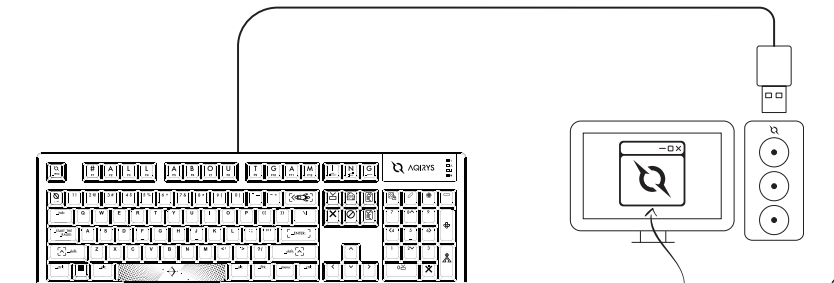

www.aqirys.com/product/ALUDRA

RO

1. Conectati cablul la tastatura folosind mufa USB Type-C.
2. Conectati tastatura la portul USB 2.0 al computerului.
3. Descarcati driver-ul (disponibil aici: www.aqirys.com/product/aludra) > Dezarhivati si instalati > Utilizati software-ul instalat pentru configurarea detaliata a tastaturii.

EN

1. Connect the cable to the keyboard using the USB Type-C terminal.
2. Connect the keyboard to the USB 2.0 port of the computer.
3. Download the software driver (available here: www.aqirys.com/product/aludra) > Unpack and install > Use the software to customize your keyboard settings.



Ghid de instalare rapida
Quick Start Guide

FUNCTII MULTIMEDIA

MULTIMEDIA SHORTCUTS

_FN + **#** F1 Player Media / Music Player

_FN + **A** F2 Volum - / Volume -

_FN + **L** F3 Volum + / Volume +

_FN + **L** F4 Oprire sunet / Mute

_FN + **A** F5 Melodia anterioara / Previous track

_FN + **B** F6 Melodia urmatoare / Next track

_FN + **O** F7 Play/Pauza / Play/Pause

_FN + **U** F8 Stop / Stop

_FN + **T** F9 Email / Email

_FN + **G** F10 Acasa / Home

_FN + **A** F11 Blocare taste / Key lock

_FN + **M** F12 Calculator / Calculator

_FN + **Windows** Blocare tasta Windows / Windows key lock



Ghid de instalare rapida
Quick Start Guide

ILUMINAREA LATERALA

SIDE BACKLIGHT

_FN + **☑** Efecte de iluminare / Illumination effects

_FN + **X** Iluminare cu o singura culoare / Single color mode

_FN + **⬆** Creste viteza iluminarii / Increase illumination speed

_FN + **⬇** Scade viteza iluminarii / Decrease illumination speed

_FN + **☑** Creste luminozitatea / Increase illumination brightness

_FN + **☑** Scade luminozitatea / Decrease illumination brightness

RO Nota: indicatorii LED vor ilumina intermitent de 3 ori atunci cand selectati ultimul nivel de viteza sau luminozitate.

EN Note: the LED indicators will flash 3 times when you have selected the last level of speed or brightness.

ILUMINAREA TASTELOR

KEYS BACKLIGHT

_FN + **I** Modul personalizare / Customization mode

_FN + **N** Efecte de iluminare / Illumination effects

_FN + **G** Culori pentru iluminare / Illumination colors

_FN + 1/2/3: Profiluri personalizate de iluminare / Custom illumination profiles

ILUMINAREA LOGOULUI

LOGO BACKLIGHT

_FN + **☑** Culori pentru iluminare / Illumination colors



Ghid de instalare rapida
Quick Start Guide

ILUMINARE PERSONALIZATA

CUSTOM ILLUMINATION

RO

1. Selectati un profil de iluminare personalizat (FN + 1, 2 sau 3).
2. Apasati FN + Print Screen pentru a intra in modul personalizare; LED-urile de notificare se vor aprinde intermitent si iluminarea tastelor se va stinge.
3. Apasati tasta pe care o doriti iluminata (pentru modificarea sau oprirea iluminarii apasati de mai multe ori pe tasta) si repetati pana ajungeti la rezultatul dorit. Cand personalizarea este finalizata apasati din nou FN + Print Screen pentru a salva modificarile.

EN

1. Choose a custom illumination profile (FN + 1, 2, or 3).
2. Press FN + Print Screen to enter the customization mode; the notification lights will flash, and the illumination of the keys will turn off.
3. Press the key you want to keep lit (press several times to change or turn off the light) and repeat the action until you reach the desired result. When customization is complete, press FN + Print Screen again to save the changes.

AJUSTAREA LUMINOZITATII

BRIGHTNESS ADJUSTMENT

1. Apasati FN + Sageata Sus pentru a creste luminozitatea.
2. Apasati FN + Sageata Jos pentru a scadea luminozitatea.

Nota: sunt disponibile 5 niveluri de luminozitate; indicatorii LED vor ilumina intermitent de 3 ori atunci cand selectati ultimul nivel.

EN

1. Press FN + Up Arrow to increase the brightness.
2. Press FN + Down Arrow to decrease the brightness.

Nota: there are 5 levels of brightness available; the LED indicators will flash 3 times when you have selected the last level.

VITEZA ILUMINARI

BACKLIGHT SPEED

- RO**
1. Apasati FN + Sageata Dreapta pentru a creste viteza.
 2. Apasati FN + Sageata Stanga pentru a scadea viteza.

Nota: sunt disponibile 5 niveluri de viteza; indicatorii LED vor ilumina intermitent de 3 ori atunci cand selectati ultimul nivel.

- EN**
1. Press FN + Right Arrow to increase the speed.
 2. Press FN + Left Arrow to decrease the speed.

Note: there are 5 levels of speed available; the LED indicators will flash 3 times when you have selected the last level.

RESETARE TASTATURA

FACTORY RESET

- RO**
- Apasati FN + ESC timp de 3 secunde pentru a reseta tastatura la setarile din fabrica.
- EN**
- Press FN + ESC for 3 seconds to reset the keyboard to factory settings.

SCOATEREA TASTELOR

KEYCAP REMOVAL

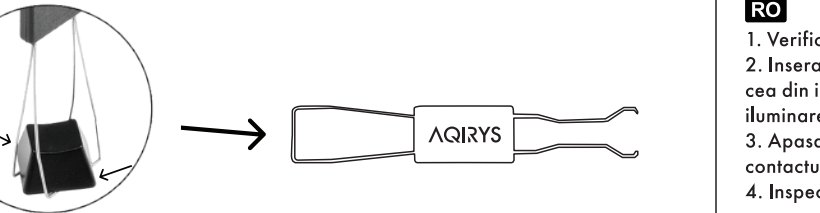

- RO**
- Folosind instrumentul de extragere a capacului de taste, alinai-l in diagonala cu tasta pe care doriti să o inlocuiti si trageți ușor in timp ce tineti apasate clemele.
- EN**
- Using the keycap extraction tool, line up diagonally with the key you want to replace and gently pull while holding down the clips.

SCOATEREA CONTACTELOR

SWITCH REMOVAL

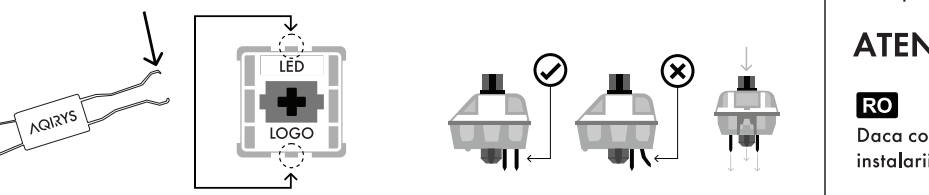

- RO**
1. Folosind instrumentul de indepartare a contactelor mecanice, alinaii dintii de prindere vertical (pe axa Y) in centrul contactului, asa cum se vede in imaginea de mai sus.
 2. Prindeți contactul mecanic si aplicati presiune pana cand acesta se elibereaza de pe placa PCB.
 3. Cu fermitate, dar atentie, scoateti contactul din tastatura printr-o miscare verticala.
- EN**
1. Using the Switch Removal Tool, align the clamping teeth vertically (on the Y-Axis) at the center of the switch, as shown in the picture above.
 2. Grab the switch and apply pressure until the switch releases itself from the PCB plate.
 3. Using firm but gentle force pull the switch away from the keyboard using a vertical motion.

INSTALAREA CONTACTELOR

SWITCH INSTALLATION

- RO**
1. Verificati daca toti pini metalici ai contactului mecanic sunt perfect drepti si curati.
 2. Inserati contactul mecanic in locul specific asigurandu-va ca pozitia lui este similara cu cea din ilustratie: logo-ul orientat spre partea inferioara a tastaturii si zona decupata pentru iluminarea LED orientata spre partea superioara a tastaturii.
 3. Apasati contactul mecanic in jos pana cand auziti un clic. Aceasta inseamna ca pini contactului mecanic s-au atasat la placa tastaturii.
 4. Inspectati contactul mecanic pentru a va asigura ca este atasat corect la tastatura si testati-l.
- EN**
1. Check that all metallic pins of the switch are perfectly straight and clean.
 2. Insert the mechanical switch in the specific location making sure that its position is similar to the one in the illustration: the logo facing the bottom of the keyboard and the recessed area for the LED illumination facing the top of the keyboard.
 3. Press the switch down until you hear a click. This means your switch clips have attached themselves to the keyboard plate.
 4. Inspect the switch to ensure it is correctly attached to the keyboard, and test it.

ATENȚIE!

- RO**
- Daca contactul mecanic nu functioneaza, este posibil sa fi indoit unul dintre pini in timpul instalarii. Scoateti contactul mecanic si incercati, cu mare atentie, sa indreptati pinul indoit.

Daca procesul de instalare nu este efectuat corect pini pot fi deteriorati iremediabil, necesitand inlocuirea completa a contactului mecanic, **acest lucru nefiind acoperit de garantia produsului.**

- EN**
- If the mechanical switch does not work, you may have bent one of the pins during installation. Remove the mechanical switch and carefully try to straighten the bent pin.

If the installation process is not carried out correctly the pins may be irreparably damaged, requiring complete replacement of the switch, **which is not covered by the product warranty.**

PERIE MULTI-TOOL

MULTI-TOOL BRUSH

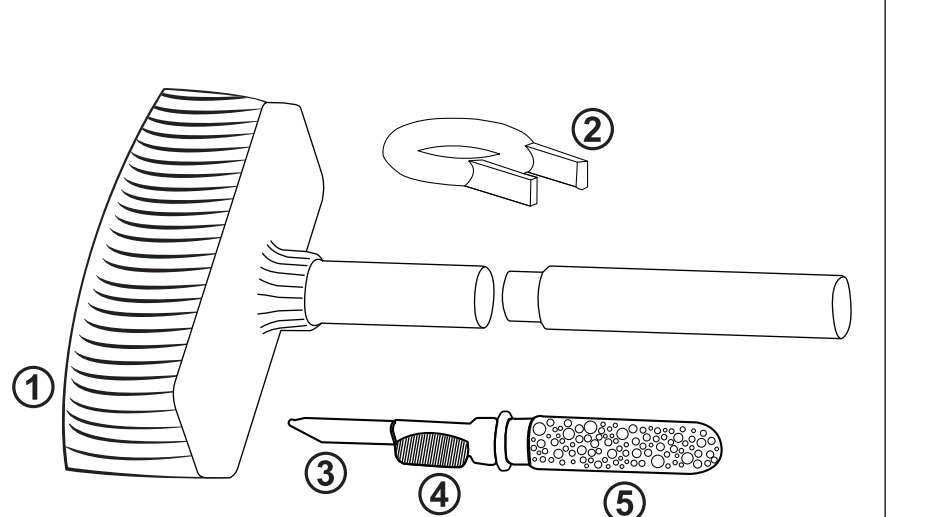

- RO**
1. Perie pentru curatare
 2. Extractor pentru capacele tastelor
 3. Varf metalic tip stilou
 4. Perie cu densitate mare
 5. Burete cu densitate mare
- EN**
1. Cleaning brush
 2. Keycap extractor
 3. Pen-type metal tip
 4. High density brush
 5. High density sponge

WARNING!

RO

Daca contactul mecanic nu functioneaza, este posibil sa fi indoit unul dintre pini in timpul instalarii. Scoateti contactul mecanic si incercati, cu mare atentie, sa indreptati pinul indoit.

Daca procesul de instalare nu este efectuat corect pini pot fi deteriorati iremediabil, necesitand inlocuirea completa a contactului mecanic, **acest lucru nefiind acoperit de garantia produsului.**

- EN**
- If the mechanical switch does not work, you may have bent one of the pins during installation. Remove the mechanical switch and carefully try to straighten the bent pin.

If the installation process is not carried out correctly the pins may be irreparably damaged, requiring complete replacement of the switch, **which is not covered by the product warranty.**

SUPPORT

SUPPORT

- RO**
- Daca intampinati erori sau orice alte probleme in utilizarea produsului nu ezitati sa ne contactati.
- EN**
- If you encounter errors or any other problems with the mouse don't hesitate to contact us.



© AQIRYS®. All rights reserved. AQIRYS® name and logo and all other related products, service names, and design marks are trademarks or registered trademarks of PC-coolers SRL. All other brand names and trademarks are the property of their respective owners. Specifications and design are subject to change without notice due to product improvements.

REGLEMENTARI

REGULATORY

- Unauthorized repairs or disassembly of the product will void the warranty and may cause its damage.
- Jedná se o bezpečný výrobek v souladu s požiadavkami EÚ. (Respektuje smernicu o EMC (2014/30/EU))
- This product is manufactured conforming with the European RoHS standard. (compliant with directive RoHS 2.0 (2015/863/EU))
- Using the WEEE symbol (the cross-out bin) indicates that the electrical and electronic equipment inside the package can be recycled. When recycling waste properly, you protect the environment and people's health. Segregated household waste collection, aids recycle materials and components used for the production of this device. For detailed information about recycling, please contact your retailer or a local authority.

- Reparatiile neautorizate sau dezambalarea produsului duc la anulara garantiei si pot cauza deteriorarea lui.
- Produsul este unul sigur, conform cu cerintele UE. (respecta directiva EMC (2014/30/EU))
- Acest produs este fabricat in concordanta cu standardul european RoHS. (respectiva directiva RoHS 2.0 (2015/863/EU))
- Utilizarea simbolului WEEE (paubelle taota cu un X) indica faptul ca echipamentele electrice si electronice din interiorul ambalajului pot fi reciclate. Cand reciclati deseurile in mod corespunzator protejati mediul inconjurator. Colectarea selectiva ajuta la recidarea materialelor si componentelor folosite la fabricarea acestui echipament. Pentru informatii detaliate privind recidarea, va rugam sa contactati vanzatorul sau autoritatea locale.

- Nicht autorisierte Reparaturen oder Demontagen des Produkts führen zur Löschung der Garantie und möglicherweise zur Beschädigung des Produktes.
- Le produit est sûr, conformément aux exigences de l'UE. (respecte la directive CEM (2014/30/UE))
- Ce produit est fabriqué conformément à la norme européenne RoHS. (respecte la directive RoHS 2.0 (2015/863/EU))
- L'utilisation du symbole DEEE (paubelle barrée d'une croix) indique que les équipements électriques et électroniques de l'intérieur de l'emballage peuvent être recyclés. Lorsque vous recyclez correctement les déchets, vous protégez l'environnement. La collecte sélective aide au recyclage des matériaux et des composants utilisés à la fabrication de cet équipement. Pour obtenir des informations détaillées sur le recyclage, veuillez contacter le vendeur ou les autorités locales.

- Nicht autorisierte Reparaturen oder Demontagen des Produkts führen zur Löschung der Garantie und möglicherweise zur Beschädigung des Produktes.
- Das Produkt ist nach den Anforderungen der EU sicher. (EMV Verordnung (2014/30/UE))
- Dieses Produkt wird gemäß der europäischen RoHS-Norm hergestellt. (RoHS Verordnung 2.0 (2015/863/EU))
- Die Verwendung des WEEE-Symbols (mit einem X durchgestrichene Tonne) zeigt an, dass die elektrischen und elektronischen Geräte in der Verpackung recycelt werden können. Wenn Sie Abfälle ordnungsgemäß recyceln, tragen Sie zum Umweltschutz bei. Die Abfalltrennung hilft beim Recycling von Materialien und Bauteilen, die bei der Herstellung dieser Geräte verwendet werden. Ausführliche Informationen zum Recycling erhalten Sie von Ihrem Händler oder den örtlichen Behörden.

- Le riparazioni non autorizzate o lo smontaggio del prodotto portano all'annullamento della garanzia e possono causare il suo danneggiamento
- Il prodotto è sicuro, in conformità ai requisiti dell'UE (rispetta la direttiva EMC (2014/30/UE))
- Questo prodotto è fabbricato in conformità alla norma europea RoHS. (rispetta la direttiva RoHS 2.0 (2015/863/EU))
- L'uso del simbolo WEEE (cestino tagliato da una croce) indica che le apparecchiature elettriche ed elettroniche trovate all'interno della confezione possono essere riciclate. Quando riciclate i rifiuti in maniera adeguata, proteggete l'ambiente. La raccolta selettiva aiuta a riciclare i materiali e i componenti utilizzati per la fabbricazione di questo attrezzatura. Per informazioni dettagliate sul riciclaggio, contattate il venditore o le autorità locali.

- Neoprávnené opravy alebo demontáž výrobku vedou ke zrušeniu záruky a môžu spôsobiť jeho poškodenie.
- Jedná se o bezpečný výrobek v souladu s požadavky EU. (respektuje smernici o EMC (2014/30/EU))
- Tento produkt je vyroben v souladu s evropskou normou RoHS. (je v souladu se směrnicí RoHS 2.0 (2015/863/EU))
- Použití symbolu WEEE (odpadkový kôš, ktorý je preškrtnutý s X) naznačuje, že elektrické a elektronické zariadenia z vnútra balenia jsou vhodné k recyklaci. Ak riadne recyklujete odpad, chránite životné prostredie. Selektívny zber pomáha recyklovať materiály a komponenty používané pri výrobe tohto zariadenia. Za podrobnejšie informácie o recyklácii, kontaktujte prosím predajcu alebo miestne úrady.

- A termék biztonságos, gyártása EU-s normáknak megfelelő. (EMC/2014/30/EU)
- A termék gyártása az európai RoHS standard normatívának megfelelő. (RoHS 2.0 (2015/863/EU))
- A WEEE jelölés (áthúzott kukorika szimbólum) jelzi, hogy a csomagban található elektronikus alkatrészek újrahasznosíthatók. A hulladék megfelelő újrahasznosításával védi környezetét. A szelektív gyűjtéskor hozzájárul ezen termék gyártásához használt anyagok és alkatrészek újrahasznosításához. Bővebb tájékoztatásért kérjük igényelje a részleteket a forgalmazótól vagy a helyhatósági szervek képviselőitől.



REGLEMENTARI

REGULATORY

- Neoprávnené opravy alebo demontáž výrobku vedú k zrušeniu záruky a môžu spôsobiť jeho poškodenie.
- Jedná sa o bezpečný výrobek v súlade s požiadavkami EÚ. (Respektuje smernicu o EMC (2014/30/EU))
- Tento produkt je vyrobený v súlade s európskou normou RoHS. (splňa smernicu RoHS 2.0 (2015/863 / EU))
- Použitie symbolu WEEE (odpadkový kôš, ktorý je preškrtnutý s X) naznačuje, že elektrické a elektronické zariadenia z vnútra balenia sú vhodné na recykláciu. Ak riadne recyklujete odpad, chránite životné prostredie. Selektívny zber pomáha recyklovať materiály a komponenty používané pri výrobe tohto zariadenia. Za podrobnejšie informácie o recyklácii, kontaktujte prosím predajcu alebo miestne úrady.

- Neautorizované opravy alebo demontáž výrobku vedú k anuliraniu garantije i mogu voditi do oštećenja uređaja.
- Proizvod jeste bezbedan, u skladu sa zahtevima EU. (poštuj direktivu EMC (2014/30/EU))
- Ovaj proizvod proizveden je u skladu sa evropskim standardom ROHS (odnosno direktiva ROHS 2.0. (2015/863/EU)).
- Upotreba simbola WEEE (kanta isečena sa X) pokazuje činjenicu da sve električne i elektroelektroničke opreme iz ambalaže mogu biti reciklirani. Kada vršite reciklažu otpada na odgovarajući način štite životnu sredinu. Selektivna kolekcija pomaže u reciklažu materijala i komponenta upotrebljenih u proizvodnji opreme. Za detaljne informacije u odnosu na reciklažu, molimo vas da stupite u kontaktu sa vašim prodavcem ili lokalnim vlastima.

- Μη εξουσιοδοτημένες επισκευές ή αποσυμπακώση του προϊόντος επιφέρουν ακύρωση της εγγύησης και μπορούν να προκαλέσουν την αλλοίωση του.
- Το προϊόν είναι ασφαλές, σε συμμόρφωση με τις απαιτήσεις της Ε.Ε. (συγκριμένα την οδηγία EMC (2014/30/EU))
- Αυτό το προϊόν κατασκευάζεται σύμφωνα με το ευρωπαϊκό πρότυπο RoHS. (συγκεκριμένα την οδηγία RoHS 2.0 (2015/863/EU)).
- Η χρήση του συμβόλου WEEE (διαγραμμένος κάδος απορριμάτων με ένα X) υποδεικνύει πως ο ηλεκτρικός και ηλεκτρονικός εξοπλισμός του εσωτερικού του αμπαλάζ μπορούν να ανακυκλωθούν. Όταν ανακυκλώνεται τα απόβλητα με αποδεδειγμένο προστατεύεται τον περιβάλλον. Η επιλεκτική συλλογή βοηθά στην ανακύκλωση των υλικών και εξαρτημάτων που χρησιμοποιούνται στην παραγωγή αυτού του εξοπλισμού. Για λεπτομερείς πληροφορίες σχετικά με την ανακύκλωση, παρακαλούμε να επικοινωνήσετε με τον πωλητή ή τις τοπικές αρχές.

- Неотризираните ремонтни работи или разпаковането на продукта водят до нищожество на гаранцията и могат да доведат до неговата повреда.
- Продуктът е само една бройка, в съответствие с изискванията на ЕС. (Спазва разпореджанията на Директивата EMC (2014/30/ЕС))
- Този продукт е произведен в съответствие с европейския стандарт RoHS. (Съответствашите Директива RoHS 2.0 (2015/863/ЕС))
- Отпазването на символна WEEE (зачеркната с X кофа за отпадъци) посочва факта, че електричните и електронните устройства в опаковката могат да се рециклират. При надлежно рециклиране, опазвате околната среда. Разделното събиране на отпадъците помага за рециклирането на употребените материали и съставки за изработване на това устройство. За подробни информации относно рециклирането, молим Ви да се свържете с продавача на устройството или местните власти.

- Nieautoryzowane naprawy lub demontaż produktu spowodują utratę gwarancji i mogą spowodować jego uszkodzenie.
- Produkt bezpieczny, zgodny z wymogami UE. (przestrzega dyrektywę EMC (2014/30/UE))
- Ten produkt został wyprodukowany zgodnie z europejską normą RoHS. (odpowiednio dyrektywę RoHS 2.0 (2015/863 / UE))
- Użycie symbolu WEEE (kosz na śmieci z X) oznacza, że sprzęt elektryczny i elektroniczny wewnątrz opakowania można poddać recyklingowi. Poprzez prawidłowy recykling odpadów chronisz środowisko. Selektivna zbiórka pomaga w recyklingu materiałów i komponentów użytych do produkcji tego sprzętu. Aby uzyskać szczegółowe informacje dotyczące recyklingu, skontaktuj się ze sprzedawcą lub lokalnymi władzami.
- A termék nem szakszerű javítása vagy a termék alkatrészekre való bontása a garancia elvesítését jelenti és ugyanakkor a termék sérülését is előidézheti.



Noi, S.C. PC-coolers S.R.L. cu sediul social in Bucuresti, strada Matei Basarab, nr. 98, bloc 86, scara 2, etaj 3, apartament 40, sector 3, cu certificat de inregistrare seria J40/1005/2005 prin reprezentant legal Director General Bogdan Bistreaun, asiguram, garantam si declaram pe propria raspundere, conform prevederilor din: HG 487/2016 (privind compatibilitatea electromagnetica), HG 409/2016 (privind stabilirea conditiilor pentru punerea la dispozitie pe piata a echipamentelor electrice de joasa tensiune), OUG 5/2015 (privind deseurile de echipamente electrice si electronice) si HG 322/2013 (privind restrictiile de utilizare a anumitor substante periculoase in echipamentele electrice si electronice), ca produsul:

Tip produs	Brand	Denumire marketing	Numar model
Tastatura PC	AQIRYS	Aludra	ALUDRA

la care se refera aceasta declaratie, nu pune in pericol viata, sanatatea, securitatea muncii, nu produce un impact negativ asupra mediului, nu pune in pericol securitatea oamenilor, animalelor domestice si bunurilor mobile si imobile si este in conformitate cu urmatoarele reglementari si Directive Europene:

- RoHS 2.0 (2015/863/EU), EMC (2014/30/EU)**
- si urmatoarele Standarde Europene:
- EN 55032:2015**
EN 55035:2017
EN 61000-3-2:2014
EN 61000-3-3:2013

si urmatoarele Standarde Europene:

EN 55032:2015
EN 55035:2017
EN 61000-3-2:2014
EN 61000-3-3:2013

si urmatoarele Standarde Europene:

EN 55032:2015
EN 55035:2017
EN 61000-3-2:2014
EN 61000-3-3:2013

si urmatoarele Standarde Europene:

EN 55032:2015
EN 55035:2017
EN 61000-3-2:2014
EN 61000-3-3:2013

si urmatoarele Standarde Europene:

EN 55032:2015
EN 55035:2017
EN 61000-3-2:2014
EN 61000-3-3:2013

Importator si Distribuitor in Romania: SC PC-coolers SRL
 Adresa: Calea Vitan 154-158, sector 3, Bucuresti, Romania
 ☎ 031.433.7200 | ✉ office@pc-coolers.ro | 🌐 www.pc-coolers.ro

