



ANDROMEDA

GHID DE INSTALARE RAPIDA

QUICK START GUIDE

RO / EN

Mulumim

Thank you!

RO

Va multumim ca ati ales ca ANDROMEDA sa fie castile dumneavoastra de gaming pretutindenii! Va rugam sa urmati instructiunile din manualul de utilizare pentru a finaliza cu succes instalarea noului echipament.

#BIG #BOLD #AMPLIFIED

Welcome to the sound of AQIRYS®!

EN

Thank you for choosing ANDROMEDA to be your everywhere gaming headset! Please, follow the instructions from the enclosed user manual to successfully complete the installation of your new gear.

#BIG #BOLD #AMPLIFIED

Welcome to the sound of AQIRYS®!

Continut Pachet

Packing List

1. Casti Wireless	1. Wireless Headset
2. Microfon Detasabil	2. Removable Microphone
3. Cablu Incarcare Micro-USB	3. Micro-USB charging cable
4. Cablu Audio	4. Audio Cable
5. Manual de Utilizare	5. User Manual
6. Transmigator Wireless	6. Wireless Receiver
7. Splitter Audio	7. Audio Splitter
8. Husa de transport	8. Pouch
9. Stick USB 4 GB	9. 4 GB USB Stick
10. Mousepad	10. Mousepad
11. Set pernite textile	11. Fabric ear-pad set

Prezentarea Castilor

Headset Overview

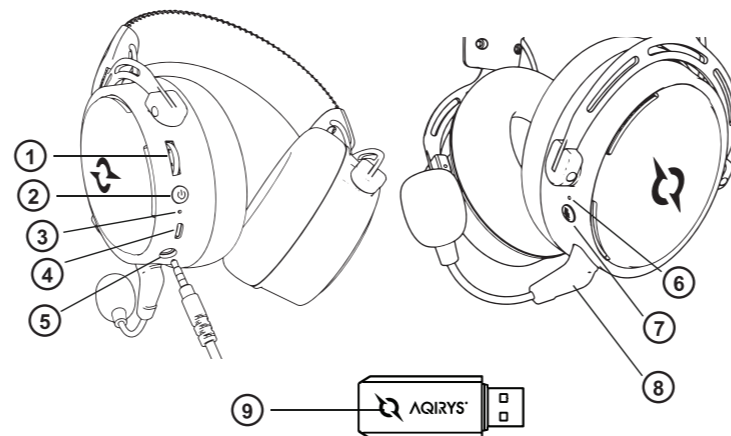

RO

1. Rotita de volum
2. Pornit/Oprit
3. Indicator LED
4. Port Incarcare Micro-USB
5. Port Audio 3.5 mm
6. Indicator LED microfon
7. Buton pornire/oprire microfon
8. Microfon detasabil
9. Transmigator Wireless

EN

1. Volume wheel
2. On / Off
3. LED Indicator
4. Micro-USB Charging Port
5. 3.5 mm Audio Port
6. Mic. LED indicator
7. Mic. On/Off Button
8. Detachable microphone
9. Wireless receiver

Conectarea Castilor

Connecting the headset

1. Fara fir

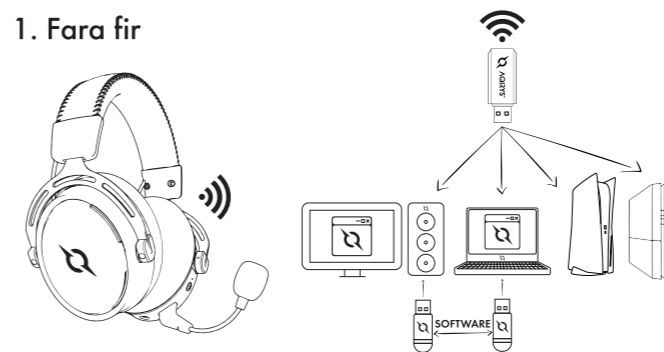

1. Wireless

RO

1. Conectati transmigatorul USB la un port disponibil pe echipamentul dumneavoastra. Driver-ul necesar va fi instalat automat, iar dispozitivul afisat cu numele "AQIRYS ANDROMEDA 7.1 Headset". Transmigatorul va intra in modul Pairing si LED-ul va lumina albastru intermitent.
2. Porniti castile si asteptati sa intre in modul Pairing;
3. Castile si transmigatorul se vor conecta automat, LED-ul transmigatorului ramanand aprins albastru.

Nota: Instalati driver-ul audio furnizat pe stick-ul USB (compatibil Microsoft Windows 7 sau mai nou). Utilizati software-ul instalat pentru configurarea detaliata a preferintelor audio.

EN

1. Connect the USB receiver to an available port on your device. The required driver will be installed automatically, and the device will be displayed with the name "AQIRYS ANDROMEDA 7.1 Headset". The receiver will enter in Pairing mode, and the LED will flash blue.
2. Turn on the headset and wait for it to enter Pairing mode; The receiver LED will be lit solid blue.
3. The headset and the receiver will connect automatically, and the receiver LED will be lit solid blue.

Nota: Install the software driver provided on the USB stick (compatible with Microsoft Windows 7 or newer). Use the sound software to fine-tune your audio preferences.

2. Cu fir via TRRS Audio Jack

2. Wired via TRRS Audio Jack



RO

Conectati mufa audio de 3.5 mm la echipamentul mobil/console > Selectati castile ca iesire audio implicita.

Nota: Cand conectati mufa audio de 3.5 mm in casti, conexiunea fara fir va fi intrerupta si castile vor intra in modul de ascultare pe fir.

EN

Connect the 3.5mm audio jack to your mobile device/console > Select the headsets as default audio output.

Nota: When you connect the 3.5 mm audio jack to the headset, the wireless connection will be disabled, and the headset will switch to wired mode.

3. Cu fir via TRS Audio Jack Splitter

3. Wired via TRS Audio Jack Splitter

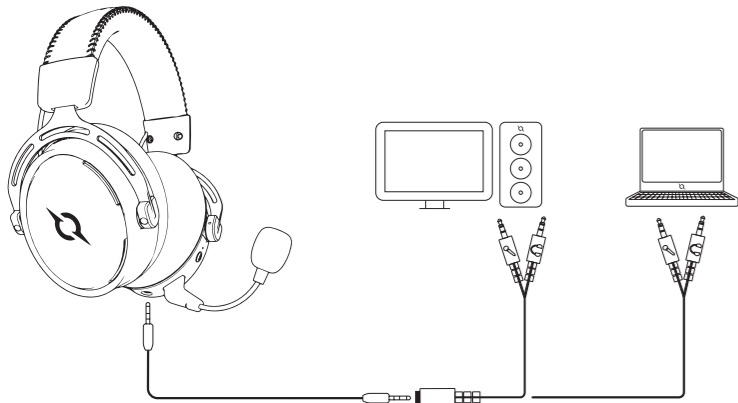

RO

Folosiți splitter-ul din pachet pentru a conecta castile la porturile line-out și microfon ale PC-ului/laptop-ului.

Nota: Cand conectati mufa audio de 3.5 mm in casti, conexiunea fara fir va fi intrerupta si castile vor intra in modul de ascultare pe fir.

EN

Use the provided splitter to connect the headset to the line-out and microphone ports on your PC/laptop.

Note: When you connect the 3.5 mm audio jack to the headset, the wireless connection will be disabled, and the headset will switch to wired mode.

Nivelul Bateriei

Battery Level

RO

In utilizare normala (70% volum), autonomia castilor este de cca 17 ore; castile va vor avertiza cand nivelul bateriei atinge pragul de 5%.

EN

In typical use (70% volume), the battery life is approx. 17 hrs; the headset will warn you when the battery level reaches the 5% threshold.

Incarcarea Bateriei

Charging the battery

RO

Cand nivelul bateriei este scazut, castile pot fi incarcate in aproximativ 7 ore utilizand cablul USB pentru incarcare. In timpul incarcarii castile se vor opri automat, iar indicatorul LED va ilumina rosu continuu. Cand bateria este incarcata complet, indicatorul LED se va stinge.

EN

When the battery level is low, it can be charged in about 7 hours using the USB charging cable. During charging, the headset will turn off automatically, and the LED indicator will illuminate solid red. When the battery charging is complete, the LED indicator will turn off.

Recomandari

Recommendation

RO

1. Pentru incarcarea bateriei puteti folosi incarcatoare 5V/1A sau 5V/2A; **voltaje mai mari pot duce la defectarea castilor.**
2. **Daca au trecut mai mult de 3 luni de la ultima utilizare a castilor va rugam sa le incarcati inainte de folosire.**
3. **Daca nu folositi castile pentru o perioada mai lunga de timp recomandam rularea unui ciclu complet de incarcare a bateriei o data la 3 luni pentru conservarea acesteia.**
4. **Inainte de prima utilizare recomandam rularea unui ciclu complet de incarcare a bateriei.**

EN

1. You can use 5V / 1A or 5V / 2A chargers to charge the battery; **higher voltages can damage the headset.**
2. **If more than 3 months have passed since the last use of the headset, please charge them before use.**
3. **If you do not use the headset for an extended time, we recommend running a complete charge cycle of the battery every 3 months to preserve it.**
4. **Before the first use, we recommend running a complete battery charge cycle.**

Atentionari

Warnings

RO

1. Pastrati castile in medii cu temperaturi normale; nu le expuneti direct razelor solare.
2. Pastrati castile la distanta de foc si obiecte fierbinti.
3. Pastrati castile uscate; evitati expunerea lor la medii umede; nu scufundati castile in lichid.
4. Nu incercati alte metode de incarcare in afara utilizarii cablului USB livrat in pachet.
5. Nu dezasamblati, reparati sau modificati castile.
6. In cazul deteriorarilor fizice (indoituri, deformari, coroziune, etc.) contactati service-ul autorizat.
7. In cazul altor probleme de genul: degajare de miros anormal, temperatura foarte mare in functionare, schimbari anormale de culoare sau forma, opriti imediat utilizarea castilor si contactati service-ul autorizat.
8. **Daca bateria este inlocuita gresit exista risc de explozie. Bateria poate fi inlocuita doar cu același tip sau un echivalent. Va rugam sa contactati service-ul autorizat.**
9. Acest produs nu este o jucarie. Copiii cu varsta mai mica de 14 ani pot utiliza produsul sub supravegherea parintilor.

EN

1. Keep the headset in environments without extreme temperatures; do not expose to direct sunlight.
2. Keep the headset away from fire and hot objects.
3. Keep the headset dry; avoid exposure to humid environments; do not immerse in liquid.
4. Do not try charging methods other than using the supplied USB cable.
5. Do not disassemble, repair or modify the headset.
6. In case of physical damage like bending, deformation, corrosion, contact the authorized service.
7. In case of other issues such as abnormal odor, very high operating temperature, abnormal changes in color or shape, stop using the headphones immediately and contact the authorized service.
8. **If the battery is replaced incorrectly, there is a risk of explosion. The battery can only be replaced with the same type or equivalent. Please contact the authorized service.**
9. This product is not a toy. Children under the age of 14 may use the product under parental supervision.

Suport

Support

If you encounter errors or any other problems with the headset don't hesitate to contact us.

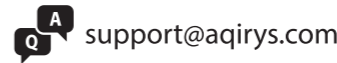

SCAN ME (Instagram Page)



SCAN ME (product page)

WARNING: Permanent hearing damage can occur if the headset is used at high volumes for extended periods of time.

ATENȚIE: Utilizarea castilor la volum maxim pentru perioade lungi de timp poate cauza deficiente permanente ale auzului.

© AQIRYS®. All rights reserved. AQIRYS® name and logo and all other related products, service names, and design marks are trademarks or registered trademarks of PC-coolers SRL. All other brand names and trademarks are the property of their respective owners. Specifications and design are subject to change without notice due to product improvements.



- Unauthorized repairs or disassembly of the product will void the warranty and may cause its damage.
 - Acest produs este fabricat în conformanță cu standardele europene RoHS. (respectiv directive RoHS 2.0 (2015/863/EU)).
 - Using the WEEE symbol (the crossed-out bin) indicates that the electrical and electronic equipment inside the package can be recycled. When recycling waste properly, you protect the environment and people health. Segregated household waste collection, aids recycle materials and components used for the production of this device. For detailed information about recycling, please contact your retailer or a local authority.

- Reparatiile neautorizate sau dezasamblarea produsului duc la anulararea a garanției și pot cauza deteriorarea lui.
 - Produsul este sigur, conform cu cerințele UE. (respectiv directive EMC (2014/30/UE), RED (2014/53/UE)).
 - Acest produs este fabricat în conformanță cu normele europene RoHS. (respectiv directive RoHS 2.0 (2015/863/EU)).
 - Utilizarea simbolului WEEE (punctul tăcut cu un X) indică faptul că echipamentele electrice și electronice din interiorul ambalajului pot fi reciclate. Când reciclați deșeurile în mod corect și separați protejii metalice incineratorilor. Colectarea selectivă ajută la reciclarea materialelor și componentelor folosite la fabricarea acestui echipament. Pentru informații detaliate privind reciclarea, va rugăm să contactați vânzătorul sau autoritatea locală.

- Les réparations non autorisées ou le déassemblage du produit portent à l'annulation de la garantie et peuvent causer son endommagement.
 - Le produit est sûr, conformément aux exigences de l'UE. (respecte la directive CEM (2014/30 / UE), RED (2014/53/UE)).
 - Ce produit est fabriqué conformément à la norme européenne RoHS. (respecte la directive RoHS 2.0 (2015/863/EU)).
 - L'utilisation du symbole WEEE (poubelle barrée d'une croix) indique que les équipements électriques et électroniques de l'intérieur de l'emballage peuvent être recyclés. Lorsque vous recyclez correctement les déchets, vous protégez l'environnement. La collecte sélective aide au recyclage des matériaux et des composants utilisés à la fabrication de cet équipement. Pour obtenir des informations détaillées sur le recyclage, veuillez contacter le vendeur ou les autorités locales.

- Nicht autorisierte Reparaturen oder Demontagen des Produkts führen zur Löschung der Garantie und möglicherweise zur Beschädigung des Produkts.
 - Das Produkt ist nach den Anforderungen der EU sicher. (EMV Verordnung (EU) 2014/30/EU, RED (2014/53/UE)).
 - Dieses Produkt wird gemäß der europäischen RoHS-Norm hergestellt. (RoHS Verordnung 2.0 (2015/863/EU)).
 - Die Verwendung des WEEE-Symbols (mit einem X durchgestrichene Tonne) zeigt an, dass die elektrischen und elektronischen Geräte in der Verpackung recycelt werden können. Wenn Sie Abfälle ordnungsgemäß recyceln, tragen Sie zum Umweltschutz bei. Die Abfalltrennung hilft beim Recycling von Materialien und Bauteilen, die bei der Herstellung dieser Geräte verwendet werden. Ausführliche Informationen zum Recycling erhalten Sie von Ihrem Händler oder den örtlichen Behörden.

- Le riparazioni non autorizzate o la smontaggio del prodotto portano all'annullamento della garanzia e possono causare il suo danneggiamento.
 - Il prodotto è sicuro, in conformità ai requisiti dell'UE (rispetto la direttiva EMC (2014/30 / UE), RED (2014/53/UE)).
 - Questo prodotto è fabbricato in conformità alle norme europee RoHS. (rispetto la direttiva RoHS 2.0 (2015/863 / UE)).
 - L'uso del simbolo WEEE (cestino tagliato da una croce) indica che le apparecchiature elettriche ed elettroniche trovate all'interno della confezione possono essere riciclate. Quando riciclate i rifiuti in maniera adeguata, proteggete l'ambiente. La raccolta selettiva aiuta a riciclare i materiali e i componenti utilizzati per la fabbricazione di questo attrezzato. Per informazioni dettagliate sul riciclaggio, contattare il venditore o le autorità locali.

- Neautorizované opravy alebo demontáž výrobku vedú k zrušeniu záruky a môžu spôsobiť jeho poškodenie.
 - Zariadenie je bezpečný výrobok v súlade s požiadavkami EÚ. (Respektuje smernicu EMC (2014/30/EU), RED (2014/53/UE)).
 - Tento produkt je vyroben v súlade s európskou normou RoHS. (je v súlade so smernicou RoHS 2.0 (2015/863/EU)).
 - Použitie symbolu WEEE (odpadkový koš, ktorý je preškrtnutý s X) naznačuje, že elektrické a elektronické zariadenia z vnútra balenia sú vhodné na recykláciu. Pokiaľ budete recyklovať odpad, chránite životnú prostredie. Selektívny zber pomôže recyklovať materiály a komponenty použité na výrobu tohto zariadenia. Za podrobnejšie informácie o recyklácii, kontaktujte prosím predajcu alebo miestnu úrad.

- Neautorizirane popravke ili otvaranje proizvoda vodi do anuliranja garancije i mogu voditi do oštećenja uređaja.
 - Proizvod jeste bezbedan, u skladu sa zahtevima EÚ. (počinu direktivu EMC (2014/30/EU), RED (2014/53/UE)).
 - Ovaý proizvod proizveden u skladu sa evropskim standardom RoHS (odgovorno direktivu RoHS 2.0. (2015/863/EU)).
 - Upotreba simbola WEEE (kanta iseceno sa X) pokazuje činjenicu da su električne i elektroničke opreme iz ambalaza mogu biti reciklirane. Kada viete reciklirate otpad na odgovarajući način štitite životnu sredinu. Selektivna kolekcija pomaže u reciklazu materijala i komponenti upotrebljenih u proizvodnji opreme. Za detaljnije informacije o recyklaciji, kontaktujte prosim predaju alebo miestnu úrad.

- Μη εξουσιοδοτημένες επισκευές ή αποσυναρμολόγηση του προϊόντος επιφέρουν ακύρωση της εγγύησης και μπορούν να προκαλέσουν την αλλοίωση του.
 - Το προϊόν είναι ασφαλές, σε απόφωση των απαιτήσεων της Ε.Ε. (συμπεριλαμβάνει την οδηγία EMC (2014/30/ΕΕ), RED (2014/53/ΕΕ)).
 - Αυτό το προϊόν κατασκευάζεται σύμφωνα με το ευρωπαϊκό πρότυπο RoHS. (συμπεριλαμβάνει την οδηγία RoHS 2.0 (2015/863/ΕΕ)).
 - Η χρήση του συμβόλου WEEE (κουβάκι κόβεται με Χ) υποδηλώνει πως οι ηλεκτρικές και ηλεκτρονικές συσκευές που εμπεριέχονται στο πακέτο μπορούν να ανακυκλωθούν. Όταν ανακυκλώνετε τα απόβλητά σας περιβαλλοντικά, Η επιλεκτική συλλογή βοηθά στην ανακύκλωση των υλικών και εξοικονομεί την χρησιμοποιώντας στην παραγωγή αυτού του εξοπλισμού. Για λεπτομερείς πληροφορίες σχετικά με την ανακύκλωση, παρακαλούμε να επικοινωνήσετε με τον πωλητή ή τις τοπικές αρχές.

- Неавторизованите ремонтни работи или разглобяването на продукта водят до нищожество на гаранцията и могат да доведат до неговата повреда.
 - Продуктът е само една бройка, в съответствие с изискванията на ЕС. (Правилно разпоредбата на Директивата EMC (2014/30/ЕС), RED (2014/53/ΕΕ)).
 - Този продукт е произведен в съответствие с европейските стандарти RoHS. (Съответстват на Директивата RoHS 2.0 (2015/863/ΕΕ)).
 - Обявяването на символа WEEE (зачеркнат с X кофа за отпадък) посочва факта, че електричните и електронните устройства в опаковката могат да се рециклират. При надлежно рециклиране, опазвате околната среда. Разделното събиране на отпадъците помага за рециклирането на използваните материали и съставки за използване на това устройство. За подробни информации относно рециклирането, моля да се свържете с продавача на устройството или местните власти.

- Neautorizovane popravke ili demontaz proizvoda sprovođuju oštećenje proizvoda i mogu sprovođivati njegovu oštećenje.
 - Produkti bezbedni, zgodni za upotrebu u EÚ. (prezastavka direktivu EMC (2014/30 / UE), RED (2014/53/UE)).
 - Ten produkt został wyprodukowany zgodnie z europejską normą RoHS. (odpowiednio dyrektywną RoHS 2.0 (2015/863 / UE)).
 - Użycie symbolu WEEE (kora z X) oznacza, że sprzęt elektryczny i elektroniczny zawarty w opakowaniu można poddać recyklingowi. Poprawne prowadzenie recyklingu odpadów chroni środowisko. Selektivna zbiórka pomaga w recyklingu materiałów i komponentów użytych do produkcji tego sprzętu. Aby uzyskać szczegółowe informacje dotyczące recyklingu, skontaktuj się ze sprzedawcą lub lokalnymi władzami.

- A termék nem szakszerű javításra vagy a termék alkotórészeire való bontásra a garancia érvénytelenül jelenti és veszélyes a termék sérülését is előidézi.
 - A termék biztonságos, megfelel a normáknak megköveteli. (EMC (2014/30/EU), RED (2014/53/UE)).
 - A termék gyártása az európai RoHS standard normatíváknak megfelel (RoHS 2.0 (2015/863/EU)).
 - A WEEE szimbólum (áthúzott kukoricszimbólum) jelzi, hogy a csomagban található elektronikus és elektromos alkatrészek újrahasznosíthatók. A hulladék megfelelő újrahasznosításával védi környezetet. A selektív hulladékgyűjtéssel hozzájárul ezen termék gyártásához használt anyagok és alkatrészek újrahasznosításához. Készült tájékoztató kézikönyv a részletek a forgalmazóval való kapcsolatban.

- Неавторизованите поправки или демонтаж на производа водят до повреда на гаранцията и могат да доведат до неговата повреда.
 - Продуктът е само една бройка, в съответствие с изискванията на ЕС. (Правилно разпоредбата на Директивата EMC (2014/30/ΕΕ), RED (2014/53/ΕΕ)).
 - Този продукт е произведен в съответствие с европейските стандарти RoHS. (Съответстват на Директивата RoHS 2.0 (2015/863/ΕΕ)).
 - Обявяването на символа WEEE (зачеркнат с X кофа за отпадък) посочва факта, че електричните и електронните устройства в опаковката могат да се рециклират. При надлежно рециклиране, опазвате околната среда. Разделното събиране на отпадъците помага за рециклирането на използваните материали и съставки за използване на това устройство. За подробни информации относно рециклирането, моля да се свържете с продавача на устройството или местните власти.