

Personalizare

Customization

1. Suportul palmei

1. Palm rest

RO Suportul palmei este magnetic si poate fi rapid detasat si inlocuit, tragand usor de marginea sa inferioara.

EN The magnetic palm rest can be easily detached and replaced by gently pulling its lower edge.

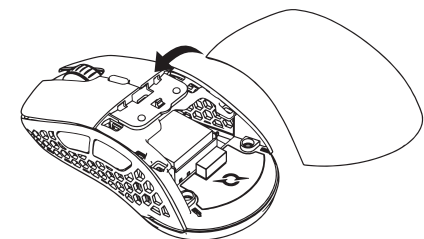
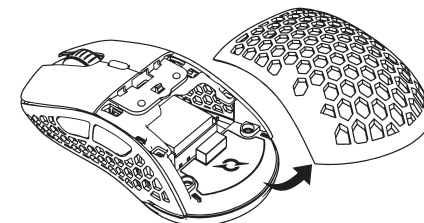

Asocierea wireless

Wireless pairing

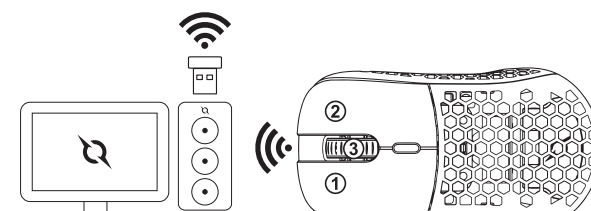

RO Comutarea intre modul wireless si modul prin cablu se face automat. Daca, din orice motiv, conexiunea wireless devine instabila, mouse-ul si receptorul pot fi re-asociate.

1. Tineti apasat butonul stanga + rotita scroll + butonul dreapta pana cand LED-ul rotitei lumineaza galben intermitent.
2. Eliberati butoanele si asezati mouse-ul langa receptor. Deconectati si apoi reconectati receptorul la portul USB. Odata ce asocierea este finalizata, rotita va inceta sa lumineze intermitent.

EN The switch between the wireless and wired mode is made automatically. If the wireless connection becomes unstable, the mouse and the receiver can be re-paired.

1. Keep pressed the Left Button + Wheel Button + Right Button until the scroll wheel LED blinks yellow.
2. Release the buttons and place the mouse near the receiver. Unplug and then replug the receiver to the USB port. Once the pairing is complete, the scroll wheel LED will stop blinking.

Indicatorul nivelului bateriei

Battery level indicator

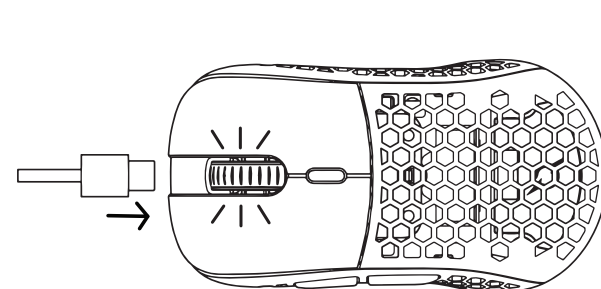

RO Cand nivelul bateriei este scazut (10%), rotita de scroll va fi iluminata rosu intermitent. Conectati mouse-ul la computer folosind cablul USB pentru a incepe incarcarea bateriei (rotita va fi iluminata portocaliu intermitent). Odata ce bateria este complet incarcata, rotita va fi iluminata verde continuu.

Note!
Pentru a conserva durata de viata a bateriei cat mai mult posibil, va recomandam sa deconectati cablul USB si sa treceti in modul wireless imediat ce incarcarea este finalizata.

EN When the battery level is low (10%), the scroll wheel LED will blink red. Connect the mouse to the PC using the USB cable to start charging the battery (the LED will blink orange). Once the battery is fully charged, the LED will turn solid green.

Note!
To preserve the battery life as much as possible, we recommend unplugging the USB cable and switching to wireless mode as soon as the charging is complete.

Iluminarea

LED System

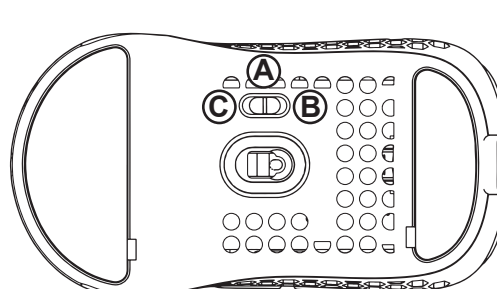

RO Pentru ca iluminarea sa se activeze corect, daca glisati comutatorul de alimentare din pozitia B in pozitia C, va rugam sa opriti si sa asteptati 3-5 secunde in pozitia A. Pentru ca iluminarea sa fie activa in modul cu fir, comutatorul de alimentare trebuie sa fie setat pe pozitia C in timp ce mouse-ul se afla in modul wireless! Culoarea LED-ului rotitei de scroll indica nivelul DPI; LED-ul DPI poate fi personalizat sau oprit pentru autonomie crescuta a bateriei prin intermediul software-ului AQIRYS.

EN For the LED system to properly activate, if sliding the power switch from position B to position C, please stop and wait for 3-5 seconds in position A. For the LED system to be active in wired mode, the power switch must be set to position C while the mouse is in wireless mode! The scroll wheel LED color indicates the DPI level; the DPI LED can be customized or turned off for prolonged battery life via AQIRYS software.

2. Fara fir

2. Wireless mode

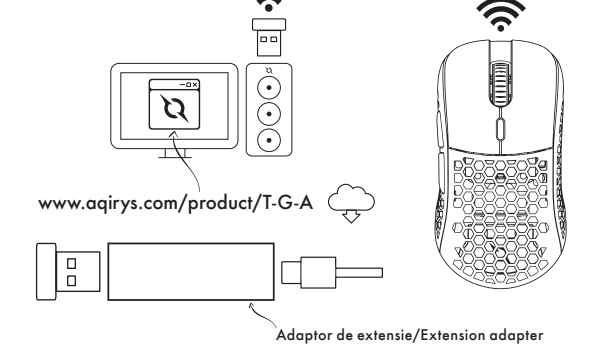

RO

1. Conectati receptorul wireless al mouse-ului la interfața USB a computerului (direct sau utilizand adaptorul de extensie inclus si cablul USB).
2. Glisati comutatorul de alimentare in pozitia pornit (8 sau 9). Mouse-ul si receptorul se vor conecta automat.
3. Descarcati driver-ul (disponibil aici: www.aqirys.com/product/t-g-a) > Dezarhivati si instalati > Utilizati software-ul instalat pentru configurarea detaliata a mouse-ului.

EN

1. Connect the wireless receiver to an available USB port on your computer (directly or using the included extension adapter and the USB cable).
2. Slide the Power switch to the ON position (8 or 9). The mouse and receiver will automatically connect.
3. Download the software driver (available here: www.aqirys.com/product/t-g-a) > Unpack and install > Use the software to customize your mouse settings.

Instalare

Setup

1. Cu fir

1. Wired mode

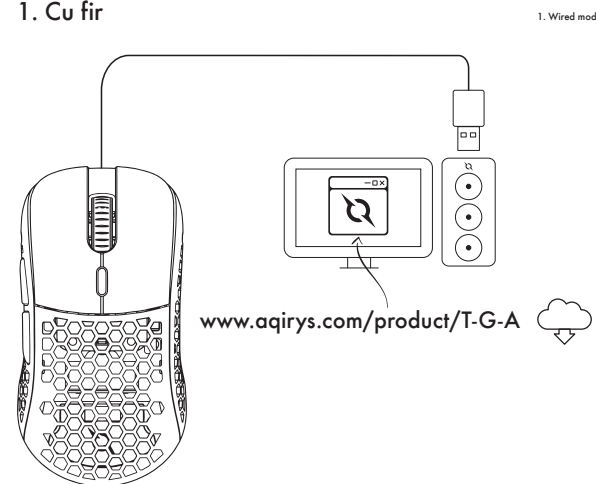

RO

1. Conectati mouse-ul la interfața USB a computerului.
2. Descarcati driver-ul (disponibil aici: www.aqirys.com/product/t-g-a) > Dezarhivati si instalati > Utilizati software-ul instalat pentru configurarea detaliata a mouse-ului.

EN

1. Connect the mouse to an available USB port on your computer.
2. Download the software driver (available here: www.aqirys.com/product/t-g-a) > Unpack and install > Use the software to customize your mouse settings.

Prezentare mouse

Mouse overview

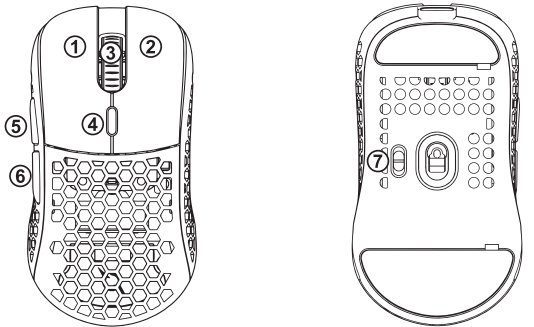

RO

1. Buton Stanga
2. Buton Dreapta
3. Rotita Scroll
4. Buton DPI
5. Buton Lateral 1
6. Buton Lateral 2
7. Mouse pornit/oprit/LED

EN

1. Left Button
2. Right Button
3. Scroll Wheel
4. DPI Button
5. Side Button 1
6. Side Button 2
7. Power ON/OFF/LED



T.G.A.

The Great Annihilator

GHID DE INSTALARE RAPIDA
QUICK START GUIDE

2. Capacul butoanelor principale

RO Capacul butoanelor principale poate fi ușor detasat și înlocuit sau personalizat. Îndepărtați suportul palmei. Împingeți ușor dar ferm țija de blocare și trageți de marginea inferioară a capacului.

EN The main buttons' cover can be easily detached and replaced or customized. Remove the palm rest. Gently but firmly push the locking pin, and pull the lower edge of the buttons cover.

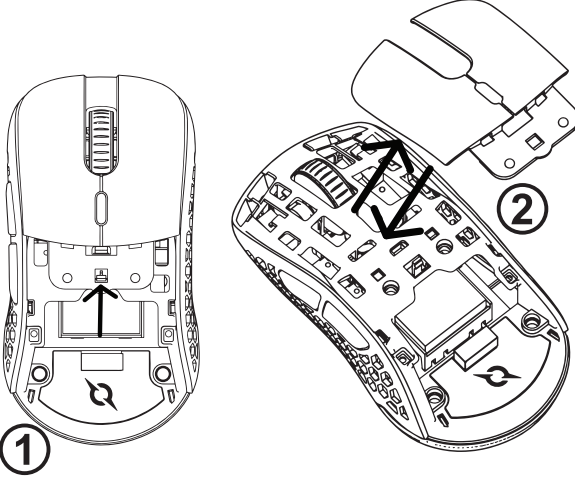

3. Feedback click Stanga/Dreapta

RO Mouse-ul dvs. vine cu un set de distanțiere de diferite grosimi care pot fi utilizate pentru a personaliza feedback-ul butoanelor stanga și dreapta. Grosimea este indicată printr-un număr pe distanțier. Va recomandăm grosimea mai mare pentru un clic cu feedback clar, tactil, și grosimea mai mică pentru un clic cu feedback ușor, moale.

EN Your mouse comes with a set of spacers of different thicknesses that can be used to customize the Left and Right buttons feedback. Thickness is indicated by a number on the spacer. We recommend the higher thickness for crisp and tactile click feedback and the lower thickness for light and soft click feedback.

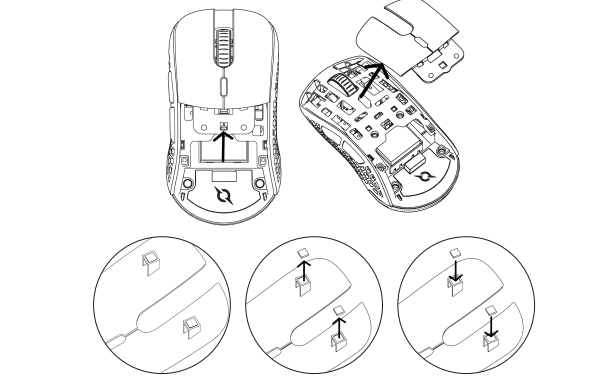

RO Detasați capacul butoanelor principale, întoarceți-l și îndepărtați ușor distanțierele instalate folosind un instrument subtire și ascuțit. Lipiți noile distanțiere în locul lor.

EN Detach the main buttons cover, flip it and gently remove the installed spacers using a sharp thin tool. Peel and stick the new spacers into place.

4. Atasarea gripurilor

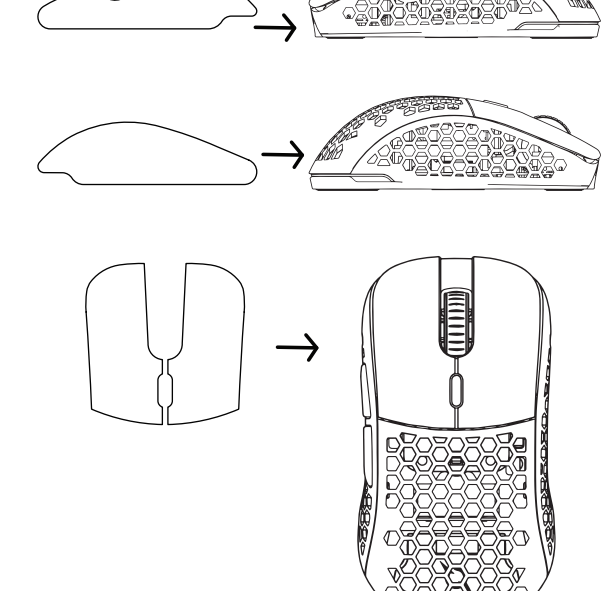

5. Înlocuirea patinelor

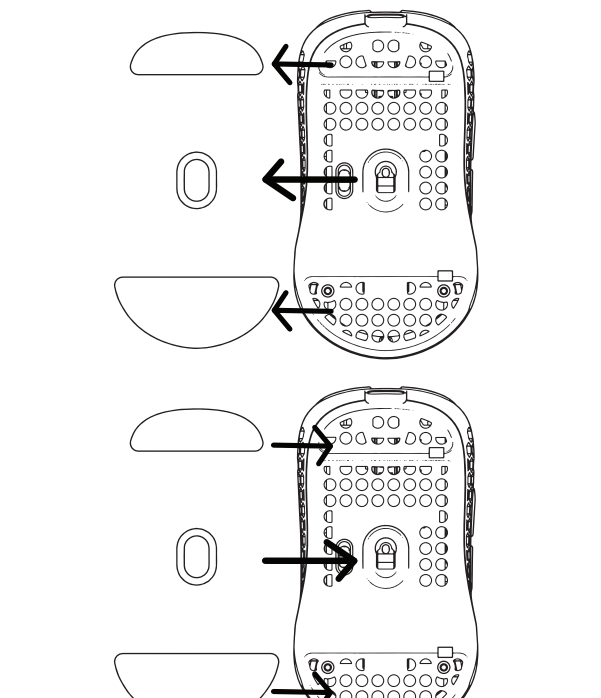

SUPPORT

RO Dacă întâmpinați erori sau orice alte probleme în utilizarea mouse-ului nu ezitați să ne contactați.

EN If you encounter errors or any other problems with the mouse don't hesitate to contact us.



© AQIRYS®. All rights reserved. AQIRYS® name and logo and all other related products, service names, and design marks are trademarks or registered trademarks of PC-coolers SRL. All other brand names and trademarks are the property of their respective owners. Specifications and design are subject to change without notice due to product improvements.

REGLEMENTARI

-Unauthorized repairs or disassembly of the product will void the warranty and may cause its damage.
-This product is safe and complies to EU requirements. [compliant with directive EMC (2014/30/EU)]
-This product is manufactured conforming with the European RoHS standard. [compliant with directive RoHS 2.0 (2015/863/EU)]
-Using the WEEE symbol (the crossed-out bin) indicates that the electrical and electronic equipment inside the packaging can be recycled. When recycling waste properly, you protect the environment and people health. Segregated household waste collection, aids recycle materials and components used for the production of this device. For detailed information about recycling, please contact your retailer or a local authority.

-Reparările neautorizate sau dezamplasarea produsului duc la anulara garanției și pot cauza deteriorarea lui.
-Produsul este sigur, conform cu cerințele UE. [respecta directiva EMC (2014/30/EU)]
-Acest produs este fabricat în conformanță cu standardul european RoHS. [respectiva directiva RoHS 2.0 (2015/863/EU)]
-Utilizarea simbolului WEEE [puștoaie tăiat cu un X] indică faptul că echipamentele electrice și electronice din interiorul ambalajului pot fi reciclate. Când reciclați deseurile în mod corect separați deșeurile medii înconjurate. Colectarea selectivă ajută la reciclarea materialelor și componentelor folosite la fabricarea acestui echipament. Pentru informații detaliate privind reciclarea, va rugăm să contactați vânzătorul sau autoritatea locală.

-Les réparations non autorisées ou le démontage du produit portent à l'annulation de la garantie et peuvent causer son endommagement.
-Le produit est sûr, conformément aux exigences de l'UE. [respecte la directive CEM (2014/30 / UE)]
-Ce produit est fabriqué conformément à la norme européenne RoHS. [respecte la directive RoHS 2.0 (2015/863/EU)]
-L'utilisation du symbole DEEE [poubelle barrée d'une croix] indique que les équipements électriques et électroniques de l'intérieur de l'emballage peuvent être recyclés. Lorsque vous recyclez correctement les déchets, vous protégez l'environnement. La collecte sélective aide au recyclage des matériaux et des composants utilisés à la fabrication de cet équipement. Pour obtenir des informations détaillées sur le recyclage, veuillez contacter le vendeur ou les autorités locales.

-Nicht autorisierte Reparaturen oder Demontagen des Produkts führen zur Löschung der Garantie und möglicherweise zur Beschädigung des Produktes.
-Das Produkt ist nach den Anforderungen der EU sicher. [EMV Verordnung (2014/30/UE)]
-Dieses Produkt wird gemäß der europäischen RoHS-Norm hergestellt. [RoHS Verordnung 2.0 (2015/863/EU)]
-Die Verwendung des WEEE-Symbols [mit einem X durchgestrichene Tonne] zeigt an, dass die elektrischen und elektronischen Geräte in der Verpackung recycelt werden können. Wenn Sie Abfälle ordnungsgemäß recyceln, tragen Sie zum Umweltschutz bei. Die Abfalltrennung hilft beim Recycling von Materialien und Bauteilen, die bei der Herstellung dieser Geräte verwendet werden. Ausführliche Informationen zum Recycling erhalten Sie von Ihrem Händler oder den örtlichen Behörden.

-Le riparazioni non autorizzate o lo smontaggio del prodotto portano all'annullamento della garanzia e possono causare il suo danneggiamento
-Il prodotto è sicuro, in conformità ai requisiti dell'UE [rispetta la direttiva EMC (2014/30 / UE)]
-Questo prodotto è fabbricato in conformità alla norma europea RoHS. [rispetta la direttiva RoHS 2.0 (2015/863 / UE)]
-L'uso del simbolo WEEE [cestino tagliato da una croce] indica che le apparecchiature elettriche ed elettroniche trovate all'interno della confezione possono essere riciclate. Quando riciclate i rifiuti in maniera adeguata, proteggete l'ambiente. La raccolta selettiva aiuta a riciclare i materiali e i componenti utilizzati per la fabbricazione di questo attrezzatura. Per informazioni dettagliate sul riciclaggio, contattare il venditore o le autorità locali.

-Неавторизоване ремонти работи или разглобяването на продукта водят до нищожество на гаранцията и могат да доведат до неговата повреда.
-Продуктът е само една бройка, в съответствие с изискванията на ЕС. [Слава разпоредбата на Директивата EMC (2014/30/EC)]
-Този продукт е произведен в съответствие с европейския стандарт RoHS. [Съответстващата Директива RoHS 2.0 (2015/863/EC)]
-Огъването на символа WEEE [зачеркната с X кофа за отпадъци] посочва факта, че електричните и електронните устройства в опаковката могат да се рециклират. При надлежно рециклиране, опазвате околната среда. Разделното събиране на отпадъците помага за рециклирането на употребяваните материали и съставки за изработване на това устройство. За подробни информации относно рециклирането, молим Ви да се свържете с продавача на устройството или местните власти.

-Niesautorizowane naprawy lub demontaż produktu spowodują utratę gwarancji i mogą spowodować jego uszkodzenie.
-Produkt bezpieczny, zgodny z wymogami UE. [przeznaczony dyrektywą EMC (2014/30 / UE)]
-Ten produkt został wyprodukowany zgodnie z europejską normą RoHS. [odpowiednio dyrektywą RoHS 2.0 (2015/863 / UE)]
-Użycie symbolu WEEE [kosz na śmieci z X] oznacza, że sprzęt elektryczny i elektroniczny wewnątrz opakowania można poddać recyklingowi. Poprzez prawidłowy recykling odpadów chronisz środowisko. Selektyny zbiórka pomaga w recyklingu materiałów i komponentów użytych do produkcji tego sprzętu. Aby uzyskać szczegółowe informacje dotyczące recyklingu, skontaktuj się ze sprzedawcą lub lokalnymi władzami.
-A termék biztonságos, gyártása EU-s normáknak megfelelő. [EMC/2014/30/EU]
-A termék gyártása az európai RoHS standard normatíváknak megfelelő [RoHS 2.0 (2015/863/EU)]
-A WEEE szimbólum [áthúzott kukasymbolum] jelzi, hogy a csomagban található elektromos és elektronikus alkatrészek újrahasznosíthatók. A hulladék megfelelő újrahasznosításával védi környezetét. A selektív hulladékgyűjtéssel hozzájárul ezen termék gyártásához használt anyagok és alkatrészek újrahasznosításához. Bővebb tájékoztatást kérjük igényelje a részleteket a forgalmazóval vagy a helyhatósággal szerez képviseletől.



REGLEMENTARI

-Неопрáвненé opravy alebo demontáž výrobku vedú k zrušeniu záruky a môžu spôsobiť jeho poškodenie.
-Jedná sa o bezpečný výrobok v súlade s požiadavkami EÚ. [Respektuje smernicu o EMC (2014/30/EU)]
-Tento produkt je vyrobený v súlade s európskou normou RoHS. [plníla smernicu RoHS 2.0 (2015/863 / EU)]
-Použitie symbolu WEEE [odpadkový kôš, ktorý je prekrítnutý s X] naznačuje, že elektrické a elektronické zariadenia z vnútra balenia sú vhodné na recykláciu. Ak riadne recyklujete odpad, chránite životné prostredie. Selektívny zber pomôže recyklovať materiály a komponenty použité pri výrobe tohto zariadenia. Za podrobnejšie informácie o recyklácii, kontaktujte prosím predajcu alebo miestne úrady.

-Неопрáвненé porovnávi ili otkvaranje proizvoda vodi do anuliranja garancije i mogu voditi do oštećenja uređaja.
-Proizvod jeste bezbedan, u skladu sa zahtevima EÚ. [poštui direktivu EMC (2014/30/EU)]
-Ovaj proizvod proizveden je u skladu sa evropskim standardom RoHS [odnosno direktive RoHS 2.0. (2015/863/EU)]
-Upotreba simbola WEEE [kanta isezena sa X] pokazuje činjenicu da sve električne i elektroelektrične opreme iz ambalaza mogu biti reciklirani. Kada vršite reciklažu otpada na odgovarajući način štite životnu sredinu. Selektivna kolekcija pomaže u reciklažu materijala i komponento upotrebljenih u proizvodnji opreme. Za detaljne informacije u odnosu na reciklažu, molimo vas da stupite u kontakt sa vašim prodavcem ili lokalnim vlastima.

-Μη εξουσιοδοτημένες επιδιορθώσεις ή αποσυναρμολόγηση του προϊόντος επιφέρουν ακύρωση της εγγύησης και μπορούν να προκαλέσουν την αλλοίωση του.
-Το προϊόν είναι ασφαλές, σε συμμόρφωση με τις απαιτήσεις της Ε.Ε. [συμμορφώμενα με την οδηγία EMC (2014/30/EU)]
-Αυτό το προϊόν κατασκευάζεται σύμφωνα με το ευρωπαϊκό πρότυπο RoHS. [συγκεκριμένα την οδηγία RoHS 2.0 (2015/863/EU)]
-Η χρήση του συμβόλου WEEE [διαγραμμένος κάδος απορριμμάτων με ένα Χ] υποδεικνύει πως ο ηλεκτρικός και ηλεκτρονικός εξοπλισμός του εσωτερικού του αφαλάτου μπορούν να ανακυκλωθούν. Όταν ανακυκλώνεται τα απόβλητα με αποδοτικό τρόπο προστατεύεται τον περιβάλλον. Η επιλεκτική συλλογή βοηθά στην ανακύκλωση των υλικών και εξαρτημάτων που χρησιμοποιούνται στην παραγωγή αυτού του εξοπλισμού. Για λεπτομερείς πληροφορίες σχετικά με την ανακύκλωση, παρακαλούμε να επικοινωνήσετε με τον πωλητή ή τις τοπικές αρχές.

-Неопрáвнени ремонтни работи или разглобяването на продукта водят до нищожество на гаранцията и могат да доведат до неговата повреда.
-Продуктът е само една бройка, в съответствие с изискванията на ЕС. [Слава разпоредбата на Директивата EMC (2014/30/EC)]
-Този продукт е произведен в съответствие с европейския стандарт RoHS. [Съответстващата Директива RoHS 2.0 (2015/863/EC)]
-Огъването на символа WEEE [зачеркната с X кофа за отпадъци] посочва факта, че електричните и електронните устройства в опаковката могат да се рециклират. При надлежно рециклиране, опазвате околната среда. Разделното събиране на отпадъците помага за рециклирането на употребяваните материали и съставки за изработване на това устройство. За подробни информации относно рециклирането, молим Ви да се свържете с продавача на устройството или местните власти.

-Niesautorizowane naprawy lub demontaż produktu spowodują utratę gwarancji i mogą spowodować jego uszkodzenie.
-Produkt bezpieczny, zgodny z wymogami UE. [przeznaczony dyrektywą EMC (2014/30 / UE)]
-Ten produkt został wyprodukowany zgodnie z europejską normą RoHS. [odpowiednio dyrektywą RoHS 2.0 (2015/863 / UE)]
-Użycie symbolu WEEE [kosz na śmieci z X] oznacza, że sprzęt elektryczny i elektroniczny wewnątrz opakowania można poddać recyklingowi. Poprzez prawidłowy recykling odpadów chronisz środowisko. Selektyny zbiórka pomaga w recyklingu materiałów i komponentów użytych do produkcji tego sprzętu. Aby uzyskać szczegółowe informacje dotyczące recyklingu, skontaktuj się ze sprzedawcą lub lokalnymi władzami.
-A termék nem szakszerű javítása vagy a termék alkatrészeire való bontása a garancia éltetését jelenti és ugyanakkor a termék sérülését is előidézi.

-Неопрáвненé opravy alebo demontáž výrobku vedú k zrušeniu záruky a môžu spôsobiť jeho poškodenie.
-Jedná sa o bezpečný výrobok v súlade s požiadavkami EÚ. [Respektuje smernicu o EMC (2014/30/EU)]
-Tento produkt je vyrobený v súlade s európskou normou RoHS. [je v súlade so smernicou RoHS 2.0 (2015/863/EU)]
-Použitie symbolu WEEE [odpadkový kôš, ktorý je prekrítnutý s X] naznačuje, že elektrické a elektronické zariadenia z vnútra balenia sú vhodné na recykláciu. Ak riadne recyklujete odpad, chránite životné prostredie. Selektívny zber pomôže recyklovať materiály a komponenty použité pri výrobe tohto zariadenia. Za podrobnejšie informácie o recyklácii, kontaktujte prosím predajcu alebo miestne úrady.

-Неопрáвненé opravy alebo demontáž výrobku vedú k zrušeniu záruky a môžu spôsobiť jeho poškodenie.
-Jedná sa o bezpečný výrobok v súlade s požiadavkami EÚ. [Respektuje smernicu o EMC (2014/30/EU)]
-Tento produkt je vyrobený v súlade s európskou normou RoHS. [je v súlade so smernicou RoHS 2.0 (2015/863/EU)]
-Použitie symbolu WEEE [odpadkový kôš, ktorý je prekrítnutý s X] naznačuje, že elektrické a elektronické zariadenia z vnútra balenia sú vhodné na recykláciu. Ak riadne recyklujete odpad, chránite životné prostredie. Selektívny zber pomôže recyklovať materiály a komponenty použité pri výrobe tohto zariadenia. Za podrobnejšie informácie o recyklácii, kontaktujte prosím predajcu alebo miestne úrady.



Noi, S.C. PC-coolers S.R.L. cu sediul social in Bucuresti, strada Matei Basarab, nr. 98, bloc 86, scara 2, etaj 3, apartament 40, sector 3, cu certificat de inregistrare seria J40/1005/2005 prin reprezentant legal Director General Bogdan Bistreanu, asiguram, garantam si declaram pe propria raspundere, conform prevederilor din: HG 487/2016 (privind compatibilitatea electromagnetica), HG 409/2016 (privind stabilirea conditiilor pentru punerea la dispozitie pe piata a echipamentelor electrice de joasa tensiune), OUG 5/2015 (privind deseurile de echipamente electrice si electronice) si HG 322/2013 (privind restrictiile de utilizare a anumitor substante periculoase in echipamentele electrice si electronice) , ca produsul:

Tip produs	Brand	Denumire marketing	Numar model
Mouse PC	AQIRYS	T.G.A.	IM10DM

la care se refera aceasta declaratie, nu pune in pericol viata, sanatatea, securitatea muncii, nu produce un impact negativ asupra mediului, nu pune in pericol securitatea oamenilor, animalelor dom estice si bunurilor mobile si imobile si este in conformitate cu urmatoarele reglementari si Directive Europene:

RoHS 2.0 (2015/863/EU), EMC (2014/30/EU), R.E.D (2014/53/EU), LVD (2014/35/EU)

si urmatoarele Standarde Europene:

EN 55032:2015
EN 55035:2017
EN 61000-3-2:2014
EN 61000-3-3:2013

Benzi de frecventa si putere (mouse si transceiver)
a. Banda (bandele) de frecventa in care functioneaza echipamentul radio:
- WiFi: 2.400 - 2.4835 GHz
b. Puterea maxima de frecventa radio transmisa in banda (bandele) de frecventa in care functioneaza echipamentul radio:
- EIRP/GFSK: 4.53 dBm (mouse)
- EIRP/GFSK: 4.34 dBm (transceiver)

Potrivit dispozitiilor HG 487/2016 si ale HG 409/2016, produsul este marcat "CE".



Prezenta declaratie fost completata folosind documentelor emise de catre Producator.



Bucuresti, 01/09/2021

Importator si Distribuitor in Romania: SC PC-coolers SRL
Adresa: Calea Vitan 154-158, sector 3, Bucuresti, Romania

☎ 031.433.7200 | ✉ office@pc-coolers.ro | 🌐 www.pc-coolers.ro

